

# GENERAL INFORMATION

## DIRECTIONS & TRANSIT

### Location

Baldwin Auditorium  
Robert H. Lurie Medical Research Center (Lurie)  
Northwestern University Chicago Campus  
303 E. Superior St, Chicago, IL 60611

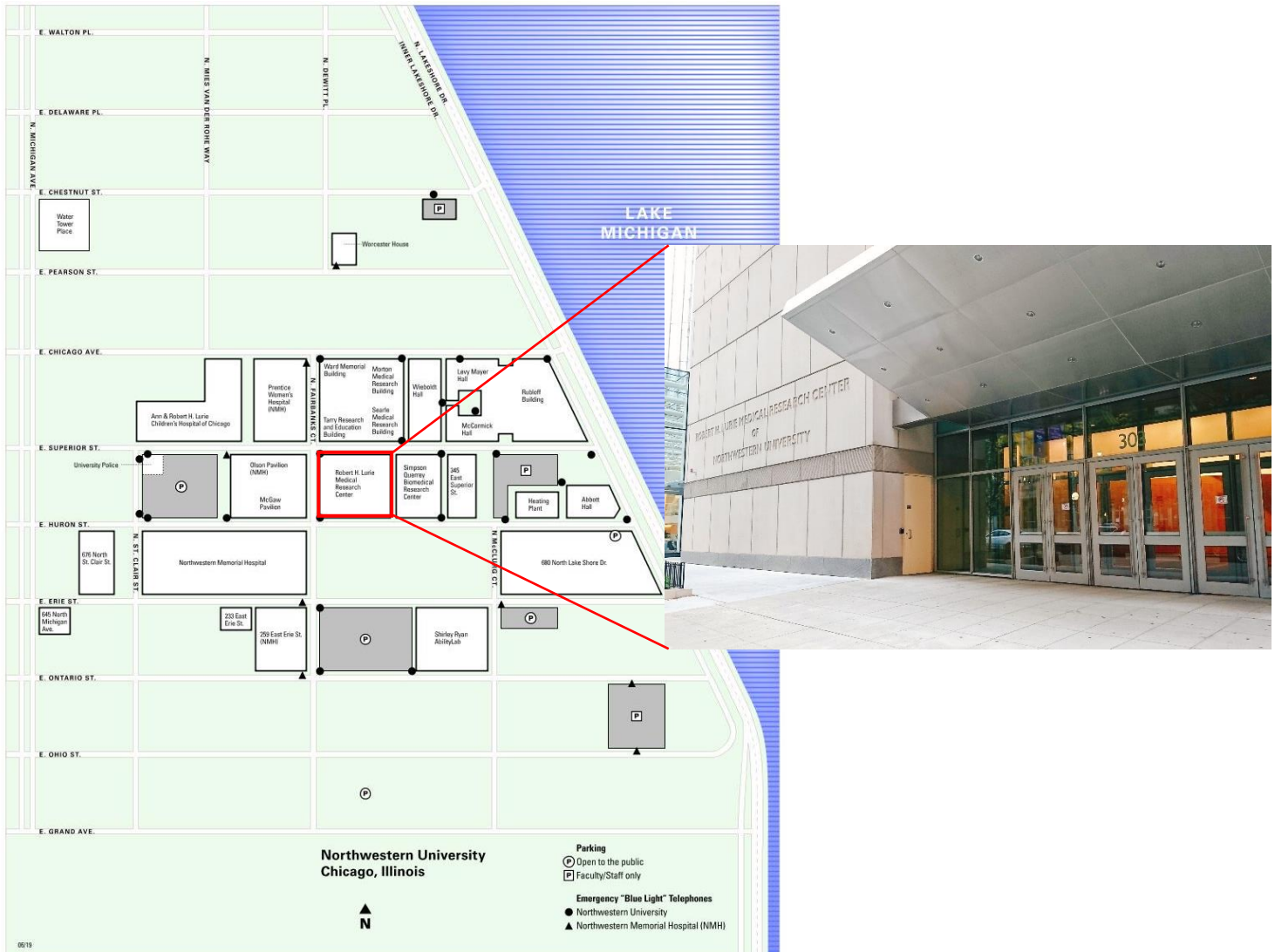

### Fly In

#### Chicago O'Hare International Airport (ORD)

- Driving: Head southeast via I-90E. Exit at 50B and take W. Ohio St to E. Superior St. (~ 40 min -1hr)
- Transit: Take CTA Blue Line (toward Forest Park) to Chicago/Milwaukee station. Transfer to Bus 66 (toward Navy Pier; Eastbound) to Fairbanks & Huron. Alternatively, transfer to Lake on the CTA Red Line at Washington and get off at Chicago/State station and walk about 10 min to Lurie. (~ 1.5 hr)

## Chicago Midway International Airport (MDW)

- Driving: Get on I-55N via S. Cicero Ave. Exit at US 41 N/ Lake Shore Drive and continue north. Turn left onto E. Chicago Ave and then N. Fairbanks Ct to E. Superior St. (~ 30 min)
- Transit: Take CTA Orange Line (toward Loop) to Roosevelt station. Transfer to CTA Red Line (toward Howard) to Chicago/State station and walk about 10 min to Lurie. (~45 min)

## Rail In

### Chicago Union Station

Take Bus 151 (toward Devon/Clark). Get off at Michigan & Huron and walk about 6 min to Lurie. (~ 25 min)

## Drive In

Please visit [Northwestern Directions](#) for specific routes that will direct you to the campus.

## Parking

There are limited metered parking (\$4 per hr) and garage parking available around campus. Use [SpotHero](#) app to reserve parking spaces in advance and get discounts (\$20 ~ \$40 in total for 9/7 8AM-8PM; ~\$10 for 9/8 8AM-1PM).



## Public Transportation

Ventra Cards are accepted on all CTA trains and buses and can be purchased at all train stations or online at [Ventra Chicago](#). Fares are \$2.50 per ride for train; \$2.25 per ride for bus; transfer (up to 2 additional rides within 2 hrs) for \$0.25. Please visit [Chicago Transit Authority \(CTA\)](#) for more information about schedules, routes, and tracker app download.

## Alternate Private Transportation

- Uber/ Lyft/ Taxi:  
303 E Superior St, Chicago, IL 60611
- Divvy bike (\$3 per ride; \$15 for a day pass). There is one bike sharing station right in front of Lurie. Please visit [Divvy Bike](#) for more information.
- Zipcar. Please visit [Zipcar Chicago](#) for nearby Zipcar locations.

## ACCOMMODATION OPTIONS

The neighborhoods around Northwestern University Chicago Campus are generally very safe at all times and are close to major tourist attractions such as Millennium Park and Navy Pier. Nearby hotels that have negotiated rates with Northwestern University are listed. Please use the link provided below to make reservation:

### - Warwick Allerton Chicago

701 North Michigan Avenue

\* Reservations are based upon room availability

Link: [MTBS 2019 Warwick Allerton Room Booking](#)

Concessions:

- Breakfast buffet for each morning included
- Wireless internet access
- 20% discount at M Avenue Restaurant and Lounge
- 24 hr cancellation

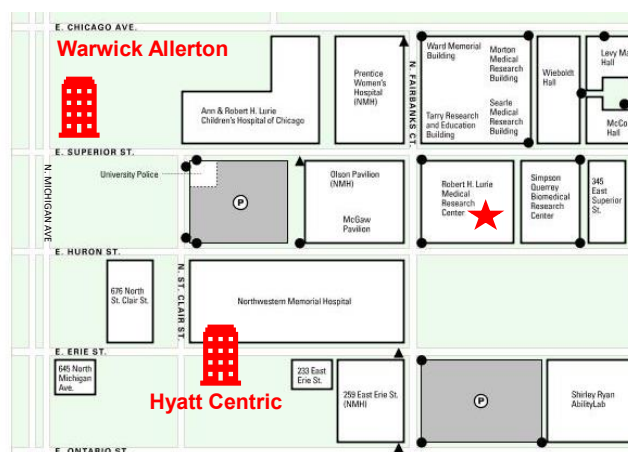

### - Hyatt Centric Chicago Magnificent Mile

633 North St. Clair Street

\* MTBS has requested a courtesy block of room for this hotel which will expire on 8/26/19

Link: [MTBS 2019 Hyatt Centric Room Booking](#)

Concessions:

- Complimentary access to fitness center and pool area
- Complimentary basic internet in guestrooms
- Complimentary local calls in guestrooms
- 72 hr cancellation

If you would like to stay a little further away from downtown Chicago (Magnificent Mile), the north side of Chicago is generally much safer than the south and the west sides. They are well connected by public transportation (e.g. CTA Red Line and Bus 147, 151) so that you can get to downtown in less than 30 min. Recommended neighborhoods closer to the event location include but are not limited to *Lincoln Park, Lake View, Uptown, Near North Side* and *River North*.

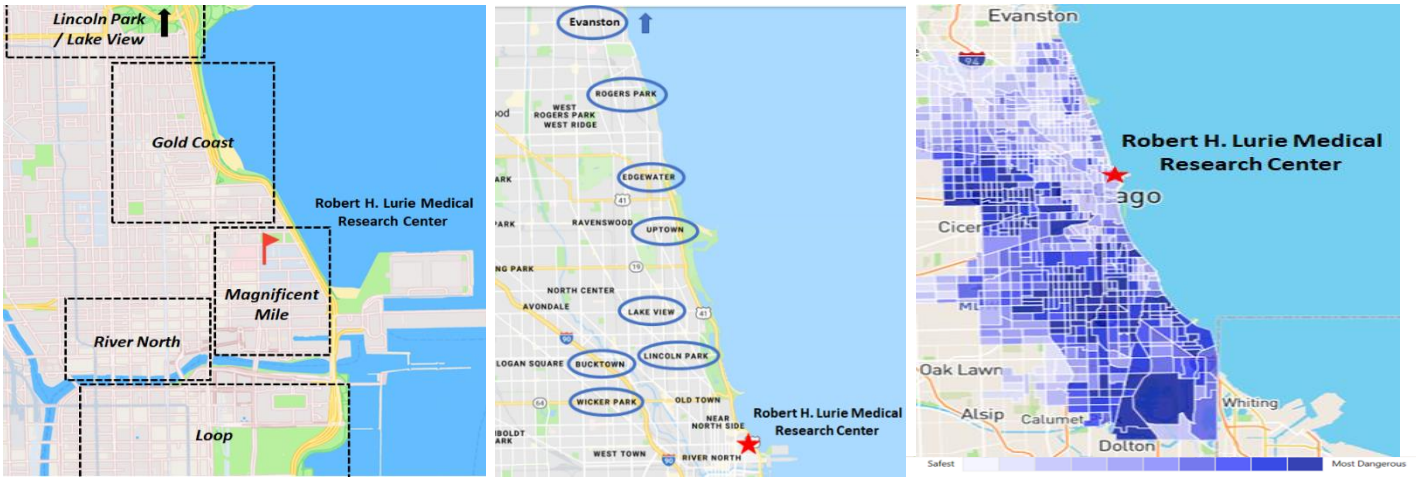

Please refer to [Neighbor Scout](https://neighbor-scout.com/) for the most up-to-date safety statistics of Chicago.

## EMERGENCIES

You can call 911 toll-free from any public telephone to obtain emergency police, fire, or medical assistance. You can also use the Emergency Police “blue light” telephones to quickly reach University Police to report crimes, suspicious activity, medical emergencies or concerns about your personal safety.

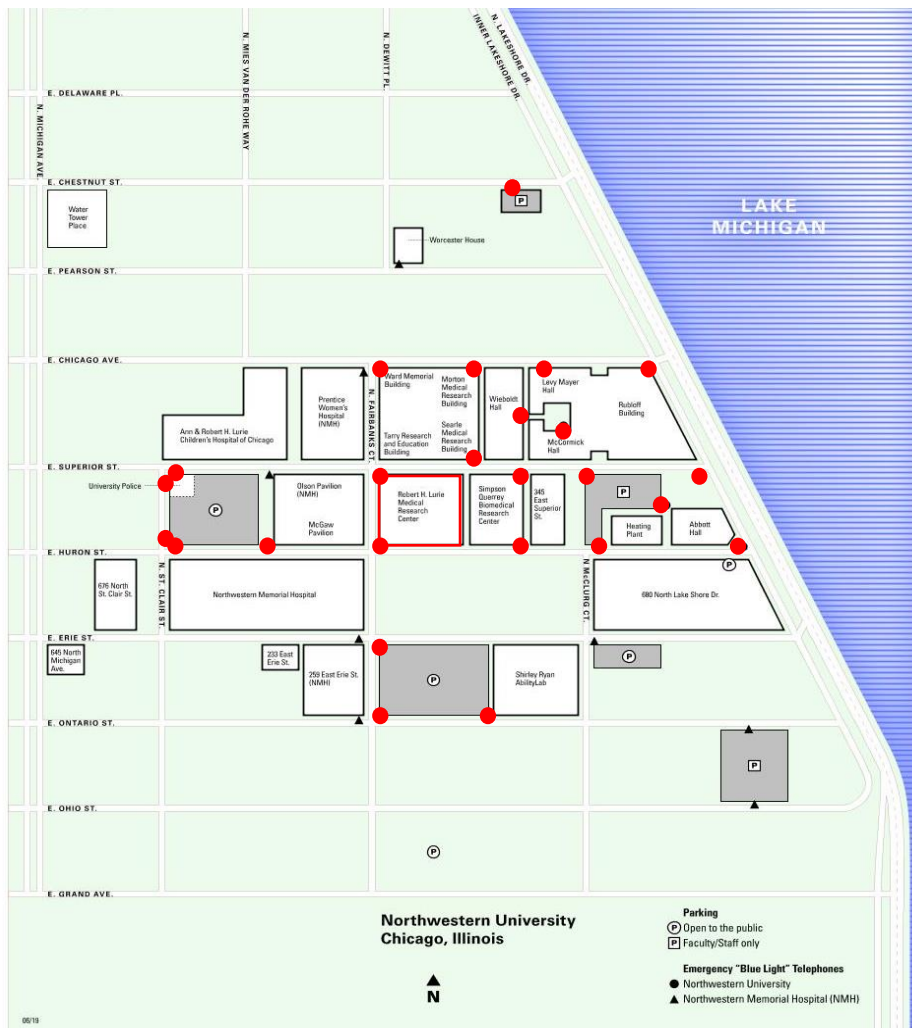

## OTHER ACCOMMODATIONS & SPECIAL NEEDS

---

The event location is wheelchair accessible and has accessible restrooms.

The campus also houses several lactation rooms. Nearby lactation room locations include the first and second floor of Prentice Women's Hospital and the second floor of Simpson Querrey Center.

Please let us know if you will need access to these rooms in advance.

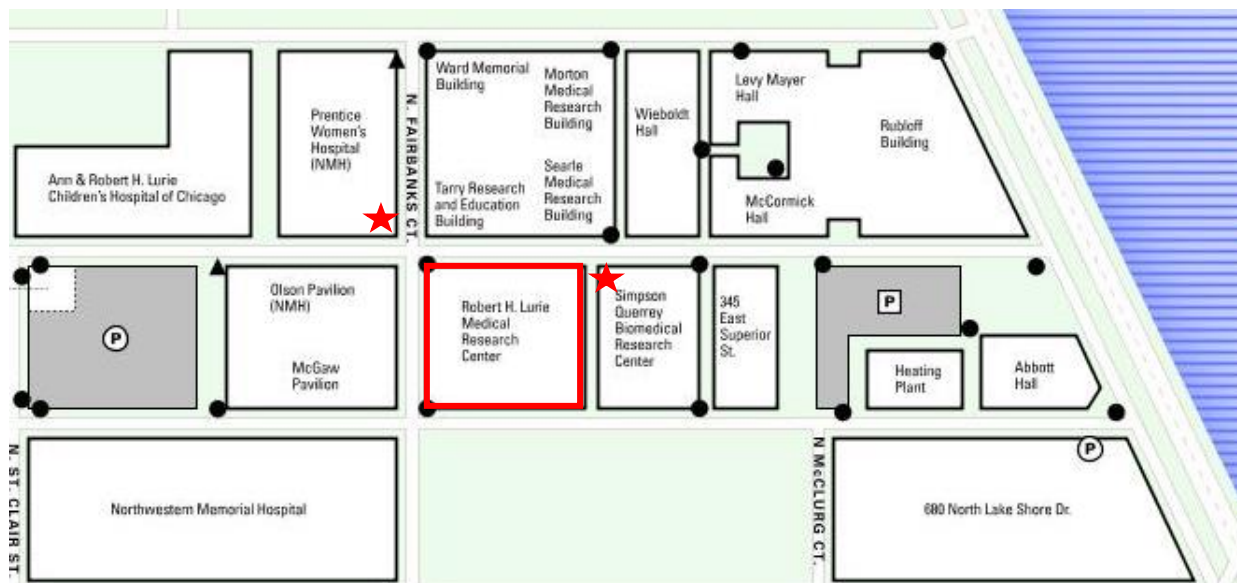

## CHICAGO TEMPERATURE

---

In September, Chicago averages a daily maximum temperature between 72-78°F (22-25°C) and a minimum temperature usually falls between 52-57°F (11-14°C). Please bring one light sweatshirt, sweater or jacket in case temperatures get chilly.

## TIME ZONE

---

Chicago is currently in Central Daylight Time (GMT/UTC – 5 hr). The State of Illinois observes daylight saving time from early March to early November.

## TAXES

---

The combined sales tax rate for Chicago, IL is 10.25%. This is the total of state, county and city sales tax rates.